



Straight Flute Tap

HSS TAPS

M

Metric coarse threads

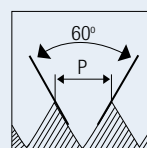

HOLE TYPE



HSS-E

DIN 371/376

6HX

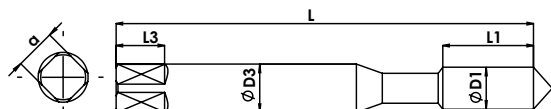

Reinforced Shank DIN371 (M3 - M10)

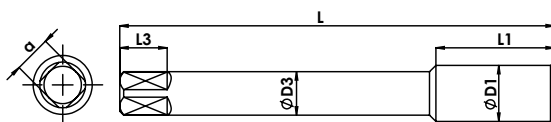

Reduced Shank DIN376 (M12 - M20)

DIN 371

DIN 376

DIN 371

DIN 376



Series	SCF5	SC4TC
Material - 1 st choice	P2-P3	K1-K3
Material - 2 nd choice	-	-
Coating	TiCN	TiAlN

DIN 371									Coating		TiCN	TiAlN
Nominal Diameter	Pitch	Overall Length	Thread Length	Shank Diameter	Square Size	Square Length	Tapping Drill Diameter	No. of Flutes	EDP No.	EDP No.		
ØD1	p	L	L1	ØD3	a	L3	Ød1					
M 3	0.5	56	11	3.5	2.7	6	2.5	3	FAB0204586	FAB0204873		
M 4	0.7	63	13	4.5	3.4	6	3.3	3	FAB0204587	FAB0204874		
M 5	0.8	70	16	6	4.9	8	4.2	3	FAB0204588	FAB0204875		
M 6	1	80	19	6	4.9	8	5	3	FAB0204589	FAB0204876		
M 8	1.25	90	22	8	6.2	9	6.8	4	FAB0204590	FAB0204877		
M 10	1.5	100	24	10	8	11	8.5	4	FAB0204591	FAB0204878		

DIN 376												
Nominal Diameter	Pitch	Overall Length	Thread Length	Shank Diameter	Square Size	Square Length	Tapping Drill Diameter	No. of Flutes	EDP No.	EDP No.		
ØD1	p	L	L1	ØD3	a	L3	Ød1					
M 12	1.75	110	28	9	7	10	10.2	4	FAB0204592	FAB0204879		
M 14	2	110	30	11	9	12	12	4	FAB0204593	FAB0204880		
M 16	2	110	32	12	9	12	14	4	FAB0204594	FAB0204881		
M 18	2.5	125	34	14	11	14	15.5	4	FAB0204939	FAB0204882		
M 20	2.5	140	34	16	12	15	17.5	4	FAB0204940	FAB0204883		

Unit : mm



Silver cut

Straight Flute Tap

M

Metric coarse threads

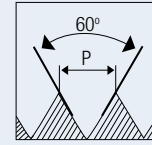

HOLE TYPE

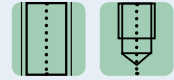

HSS-E

ISO 529

6HX

E/1.5-2P

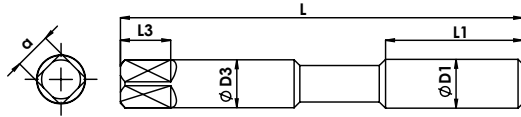

Reinforced Shank (M3 - M10)
Male centre upto M5

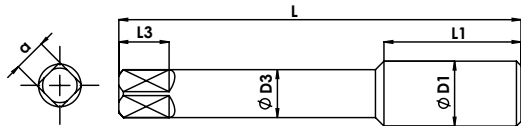

Reduced Shank (M12 - M20)

IS 6175 Part 2

IS 6175 Part 3

IS 6175 Part 2

IS 6175 Part 3

Series	SCF5	SC4TC
Material - 1 st choice	P2-P3	K1-K3
Material - 2 nd choice	-	-
Coating	TiCN	TiAlN

ISO529 / IS 6175 Part 2

Nominal Diameter	Pitch	Overall Length	Thread Length	Shank Diameter	Square Size	Square Length	Tapping Drill Diameter	No. of Flutes	EDP No.	EDP No.
									ØD1	ØD1
M 3	0.5	48	11	3.15	2.5	5	2.5	3	FAB0204616	-
M 3.5	0.6	50	13	3.55	2.8	5	2.9	3	-	-
M 4	0.7	53	13	4	3.15	6	3.3	3	FAB0204617	-
M 5	0.8	58	16	5	4	7	4.2	3	FAB0204618	FAB0205365
M 6	1	66	19	6.3	5	8	5	3	FAB0204619	FAB0205366
M 8	1.25	72	22	8	6.3	9	6.8	4	FAB0204620	FAB0205367
M 10	1.5	80	24	10	8	11	8.5	4	FAB0204621	FAB0205368

ISO529 / IS 6175 Part 3

M 12	1.75	89	29	9	7.1	10	10.2	4	FAB0204622	FAB0205369
M 14	2	95	30	11.2	9	12	12	4	FAB0204623	FAB0205370
M 16	2	102	32	12.5	10	13	14	4	FAB0204624	FAB0205371
M 20	2.5	112	37	14	11.2	14	17.5	4	FAB0205362	FAB0205372

Unit : mm



Silver cut

Straight Flute Tap

MF

Metric fine threads

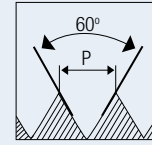

HOLE TYPE

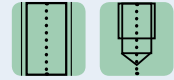

HSS-E

DIN 374

6HX

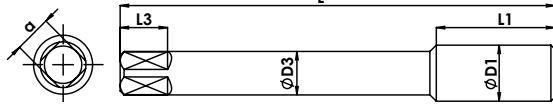

Male centre (M8 - M10)
Female centre (M12 - M20)



Series	SCF5	SC4TC
Material - 1 st choice	P2-P3	K1-K3
Material - 2 nd choice	-	-

DIN 374									Coating	TiCN	TiAlN
Nominal Diameter	Pitch	Overall Length	Thread Length	Shank Diameter	Square Size	Square Length	Tapping Drill Diameter	No. Of Flutes	EDP No.	EDP No.	
ØD1	p	L	L1	ØD3	a	L3	Ød1				
M 8	1	90	22	6	4.9	8	7	4	FAB0204595	FAB0204886	
M 10	1.25	100	24	7	5.5	8	8.8	4	FAB0204596	FAB0204888	
M 10	1	90	20	7	5.5	8	9	4	FAB0204943	FAB0204887	
M 12	1.5	100	22	9	7	10	10.5	4	FAB0204598	FAB0204890	
M 12	1.25	100	22	9	7	10	10.8	4	FAB0204597	FAB0204889	
M 14	1.5	100	22	11	9	12	12.5	4	FAB0204599	FAB0204891	
M 16	1.5	100	22	12	9	12	14.5	4	FAB0204600	FAB0204892	
M 18	1.5	110	25	14	11	14	16.5	4	FAB0204944	FAB0204893	
M 20	1.5	125	25	16	12	15	18.5	4	FAB0204945	FAB0204894	

Unit : mm



Silver cut

Straight Flute Tap

MF

Metric fine threads

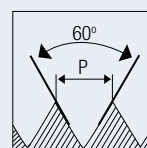

HOLE TYPE



HSS-E

ISO 529

6HX

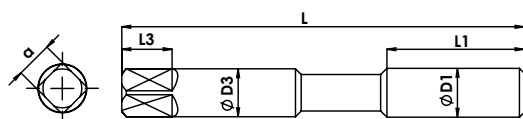

Reinforced Shank (M8 - M10)

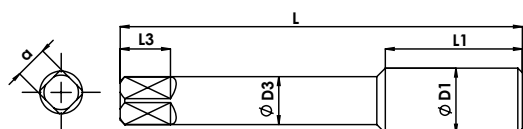

Reduced Shank (M12 - M20)

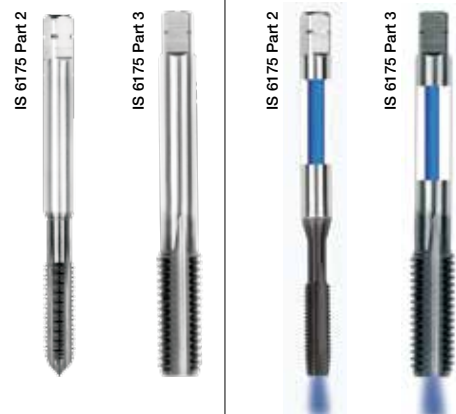

ISO529 / IS 6175 Part 2									Series	SCF5	SC4TC
Material - 1 st choice									P2-P3		K1-K3
Material - 2 nd choice									-		-
Coating									TiCN		TiAlN
Nominal Diameter	Pitch	Overall Length	Thread Length	Shank Diameter	Square Size	Square Length	Tapping Drill Diameter	No. of Flutes	EDP No.	EDP No.	
ØD1	p	L	L1	ØD3	a	L3	Ød1				
M 8	1	69	19	8	6.3	9	7	4	FAB0204625	FAB0205397	
M 10	1.25	76	20	10	8	11	8.8	4	FAB0204626	FAB0205398	

ISO529 / IS 6175 Part 3										
M	p	L	L1	ØD3	a	L3	Ød1	No. of Flutes	EDP No.	EDP No.
M 12	1.25	84	24	9	7.1	10	10.8	4	FAB0204627	FAB0205399
M 12	1.5	89	29	9	7.1	10	10.5	4	FAB0204628	FAB0205400
M 14	1.5	95	30	11.2	9	12	12.5	4	FAB0204629	FAB0205401
M 16	1.5	102	32	12.5	10	13	14.5	4	FAB0204630	FAB0205402
M 18	1.5	104	29	14	11.2	14	16.5	4	FAB0205395	FAB0205403
M 20	1.5	104	29	14	11.2	14	18.5	4	FAB0205396	FAB0205404

Unit : mm