



Solid Carbide End Mills

2 Flute

Centre cutting high performance diamond tipped end mill with corner radius



N1-N7

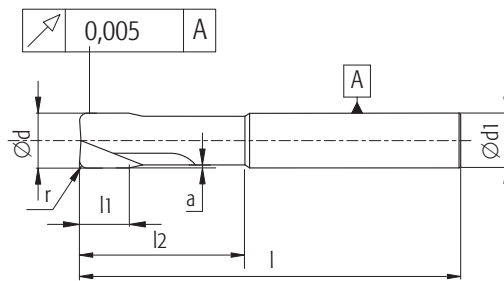

Ød (mm)	EDP No	r (mm)	Ød1 (mm)	L (mm)	L1 (mm)	L2 (mm)	a (mm)	z	γ (°)
<b>Standard</b>									
3	FBK0505977	0.3	6	78	2.5	9	0.25	2	25
3	FBK0505978	0.3	6	78	2.5	15	0.25	2	25
3	FBK0505979	0.5	6	78	2.5	9	0.25	2	25
3	FBK0505980	0.5	6	78	2.5	15	0.25	2	25
4	FBK0505981	0.3	6	78	2.5	12	0.25	2	25
4	FBK0505982	0.3	6	78	2.5	20	0.25	2	25
4	FBK0505983	0.5	6	78	2.5	12	0.25	2	25
4	FBK0505984	0.5	6	78	2.5	20	0.25	2	25
5	FBK0505985	0.3	6	78	3	15	0.3	2	25
5	FBK0505986	0.3	6	78	3	25	0.3	2	25
5	FBK0505987	0.5	6	78	3	15	0.3	2	25
5	FBK0505988	0.5	6	78	3	25	0.3	2	25
6	FBK0505989	0.3	6	102	6	18	0.3	2	-
6	FBK0505990	0.3	6	102	6	30	0.3	2	-
6	FBK0505991	0.5	6	102	6	18	0.3	2	-
6	FBK0505992	0.5	6	102	6	30	0.3	2	-
6	FBK0505993	1	6	102	6	18	0.3	2	-
6	FBK0505994	1	6	102	6	30	0.3	2	-
8	FBK0505995	0.3	8	102	7	24	0.4	2	-
8	FBK0505996	0.5	8	102	7	24	0.4	2	-
8	FBK0505997	1	8	102	7	24	0.4	2	-
10	FBK0505998	0.5	10	102	8	30	0.5	2	-
10	FBK0505999	1	10	102	8	30	0.5	2	-
12	FBK0506000	0.5	12	107	9	36	0.5	2	-
12	FBK0506001	1	12	107	9	36	0.5	2	-



## Solid Carbide End Mills

# 2 Flute

## Centre cutting high performance diamond tipped ball nose end mill



N1-N7

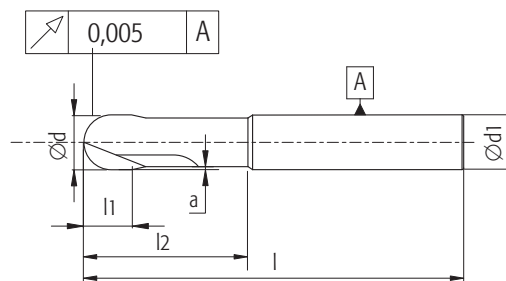

Ød (mm)	EDP No	r (mm)	Ød1 (mm)	L (mm)	L1 (mm)	L2 (mm)	a (mm)	z	γ (°)
<b>Standard</b>									
3	FBK0506014	1.5	6	78	2.5	9	0.25	2	25
3	FBK0506015	1.5	6	78	2.5	15	0.25	2	25
4	FBK0506016	2	6	78	2.5	12	0.25	2	25
4	FBK0506017	2	6	78	2.5	20	0.25	2	25
5	FBK0506018	2.5	6	78	3	15	0.3	2	25
5	FBK0506019	2.5	6	78	3	25	0.3	2	25
6	FBK0506020	3	6	102	6	18	0.3	2	-
6	FBK0506021	3	6	102	6	30	0.3	2	-
8	FBK0506022	4	8	102	7	24	0.4	2	-
8	FBK0506023	4	8	102	7	40	0.4	2	-
10	FBK0506024	5	10	102	8	30	0.5	2	-
10	FBK0506025	5	10	102	8	50	0.5	2	-
12	FBK0506026	6	12	107	9	36	0.5	2	-
12	FBK0506027	6	12	107	9	60	0.5	2	-
<b>Long</b>									
3	FBK0506028	1.5	6	78	3	9	0.1	2	15
4	FBK0506029	2	6	78	4	12	0.1	2	15
5	FBK0506030	2.5	6	78	5	15	0.1	2	15
6	FBK0506031	3	6	78	6	18	0.1	2	-
8	FBK0506032	4	8	78	8	24	0.1	2	-
10	FBK0506033	5	10	78	10	30	0.1	2	-
12	FBK0506034	6	12	78	12	30	0.1	2	-

Available in special dimensions on request.