

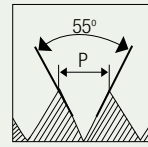

Carbon Steel Hand Taps

UNS

Unified threads special



HOLE TYPE



CS

ANSI
949

2B

T/S/B

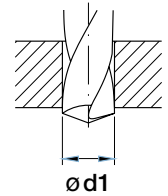
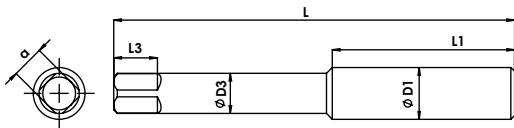

Unit : mm

Nominal Diameter	TPI	Overall Length	Thread Length	Shank Diameter	Square Size	Square Length	Tapping Drill Diameter	EDP No.
ØD1		L	L1	ØD3	a	L3	Ø d1	
1/8"	40	51.04	18.8	3.58	2.7	4.46	-	FBA0203547
5/32"	32	56.26	22.5	4.27	3.24	6.05	3.6	FBA0203631
5/32"	36	56.31	22.5	4.27	3.24	6.05	3.65	FBA0203659
7/32"	24	63.55	28.5	5.61	4.1	6.84	-	FBA0203743
7/32"	28	63.65	28.5	5.61	4.1	6.84	-	FBA0203715
7/32"	32	63.65	28.5	5.61	4.1	6.84	-	FBA0203771
3/16"	24	63.03	26.6	4.93	3.77	6.05	4.25	FBA0203799
3/16"	32	63.13	26.6	4.93	3.77	6.05	4.4	FBA0203829
1/4"	20	67.01	30.7	6.48	4.76	7.64	-	FBA0203857
1/4"	24	67.23	30.7	6.48	4.76	7.64	-	FBA0203885
1/4"	32	67.34	30.7	6.48	4.76	7.64	-	FBA0203913
5/16"	32	73.68	35.2	8.08	5.96	10.02	7.5	FBA0203941
11/16"	11	102.4	46	13.78	10.2	15.58	16.4	FBA0203969
11/16"	16	102.4	46	13.78	10.2	15.58	16.7	FBA0203997
7/8"	12	119.06	56.4	17.71	13.18	18.75	-	FBA0204053
7/8"	18	119.06	56.4	17.71	13.18	18.75	-	FBA0204025
1"	14	130.18	63.5	20.33	15.13	20.34	24.6	FBA0204081
1-1/8"	8	137.8	65	22.79	16.96	21.7	-	FBA0204137

CS TAPS



Carbon Steel Hand Taps

UNS

Unified threads special

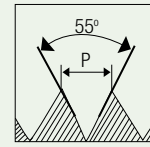

HOLE TYPE

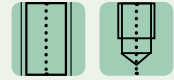

CS

ANSI 949

2B

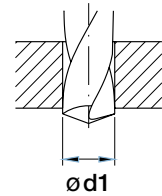
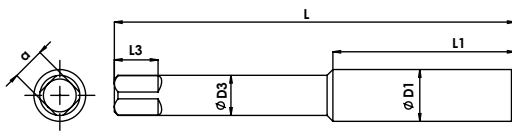

Unit : mm

CS TAPS

Nominal Diameter	TPI	Overall Length	Thread Length	Shank Diameter	Square Size	Square Length	Tapping Drill Diameter	EDP No.
ØD1		L	L1	ØD3	a	L3	Ø d1	
1-1/4"	8	145.8	65	25.96	19.34	25.2	-	FBA0204165
1-3/8"	8	153.8	76	28.17	20.99	26.7	-	FBA0204193
1-1/2"	8	161.8	76	31.35	23.38	28.2	-	FBA0204221
1-5/8"	8	169.8	81	33.18	24.75	28.2	-	FBA0204249
1-3/4"	8	177.8	81	36.35	27.12	31.7	-	FBA0204277
1-3/4"	12	177.8	81	36.35	27.12	31.7	-	FBA0204305
1-7/8"	8	185.3	90.5	38.61	28.82	31.7	-	FBA0204333
2"	8	193.3	90.5	41.79	31.21	34.7	-	FBA0204389
2"	12	193.3	90.5	41.79	31.21	34.7	-	FBA0204417