

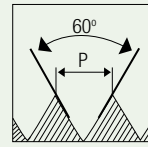

## Carbon Steel Hand Taps

# UNF

## Unified fine threads



HOLE TYPE



CS

BS  
949

2B



Nominal Diameter	TPI	Overall Length	Thread Length	Shank Diameter	Square Size	Square Length	Tapping Drill Diameter	EDP No.
ØD1		L	L1	ØD3	a	L3	Ø d1	
# 5	44	51.06	18.8	3.58	2.7	4.46	2.7	FBA0201879
# 6	40	52.85	20.6	3.58	2.7	4.46	2.95	FBA0201907
# 8	36	56.43	22.5	4.27	3.24	6.05	3.5	FBA0201963
# 10	32	63.17	26.6	4.93	3.77	6.05	4.1	FBA0201991
# 12	28	63.56	28.5	5.61	4.1	6.84	4.7	FBA0202048
1/8"	44	51.06	18.8	3.58	2.7	4.46	-	FBA0201851
5/32"	36	63.13	22.5	4.27	3.24	6.05	-	FBA0201935
3/16"	32	63.13	26.6	4.93	3.77	6.05	-	FBA0202020
1/4"	28	67.28	30.7	6.48	4.76	7.64	5.5	FBA0202077
5/16"	24	73.82	35.2	8.08	5.96	9.23	6.9	FBA0202106
3/8"	24	74.61	33.7	9.68	7.17	10.81	8.5	FBA0202135
7/16"	20	80.17	36.5	8.2	6.06	10.02	9.9	FBA0202164
1/2"	20	85.83	42.1	9.32	6.9	10.81	11.5	FBA0202193
9/16"	18	91.28	42	10.91	8.07	12.4	12.9	FBA0202222
5/8"	18	96.84	46	12.2	9.04	13.99	14.5	FBA0202252
3/4"	16	107.95	50.8	15	11.12	17.16	17.5	FBA0202281

CS TAPS



**Carbon Steel Hand Taps**

**UNF**

**Unified fine threads**

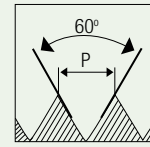

**HOLE TYPE**

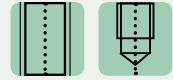

CS
BS 949
2B
T/S/B

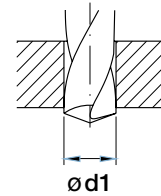
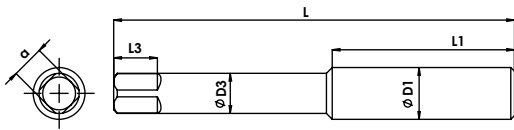

Unit : mm

CS TAPS

Nominal Diameter	TPI	Overall Length	Thread Length	Shank Diameter	Square Size	Square Length	Tapping Drill Diameter	EDP No.
ØD1		L	L1	ØD3	a	L3	Ø d1	
7/8"	14	119.06	56.4	17.71	13.18	18.75	20.4	FBA0202310
1"	12	130.18	63.5	20.33	15.13	20.34	23.25	FBA0202339
1.1/8"	12	137.8	65	22.79	16.96	21.7	26.5	FBA0202368
1.1/4"	12	145.8	65	25.96	19.34	25.2	29.5	FBA0202396
1.3/8"	12	153.8	76	28.17	20.99	26.7	32.75	FBA0202425
1.1/2"	12	161.8	76	31.35	23.38	28.2	36	FBA0202454