

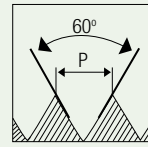

Carbon Steel Hand Taps

MF

Metric fine threads



HOLE TYPE



CS

BS
949

ZONE
5

T/S/B

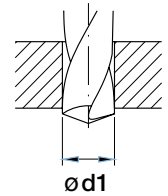
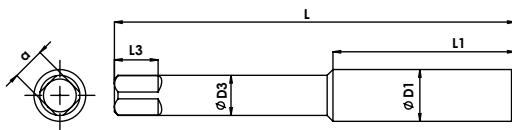

Unit : mm

Nominal Diameter	Pitch	Overall Length	Thread Length	Shank Diameter	Square Size	Square Length	Tapping Drill Diameter	EDP No.
ØD1	p	L	L1	ØD3	a	L3	Ø d1	
M 2.3	0.4	45.81	15.00	3.25	2.58	4.46	1.9	FBA0205033
M 2.6	0.45	49.16	17.00	3.25	2.58	4.46	2.1	FBA0205089
M 3	0.6	49.36	17.00	3.25	2.58	4.46	2.4	FBA0205146
M 4	0.5	56.33	22.50	4.22	3.26	6.05	3.5	FBA0205202
M 4	0.75	56.33	22.50	4.22	3.26	6.05	3.25	FBA0205259
M 5	0.5	63.29	26.60	5.41	4.15	6.05	4.5	FBA0205346
M 5	0.9	63.29	26.60	5.41	4.15	6.05	4.1	FBA0205432
M 5.5	0.9	63.58	26.60	5.61	4.30	6.05	4.6	FBA0205517
M 6	0.75	67.13	30.70	6.15	4.71	6.84	5.2	FBA0205573
M 8	0.75	69.85	30.50	8.20	6.23	8.43	7.2	FBA0205772
M 8	1	69.85	30.50	8.20	6.23	8.43	7	FBA0205800
M 9	1	74.61	33.70	9.12	6.90	10.02	8	FBA0205915
M 10	0.75	74.61	33.70	10.29	7.73	10.02	9.2	FBA0205999
M 10	1	74.61	33.70	10.29	7.73	10.02	9	FBA0206027
M 10	1.25	74.61	33.70	10.29	7.73	10.02	8.8	FBA0206059
M 12	1	76.20	31.75	9.32	6.90	10.81	11	FBA0206260
M 12	1.25	76.20	31.75	9.32	6.90	10.81	10.75	FBA0206292
M 14	1.25	76.20	31.75	10.91	8.07	12.40	12.75	FBA0206497

CS TAPS



Carbon Steel Hand Taps

MF

Metric fine threads

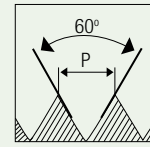

HOLE TYPE



CS

BS
949

ZONE
5

T/S/B

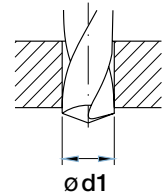
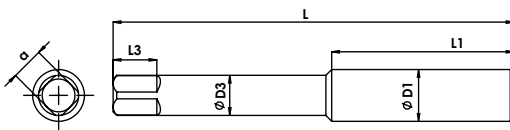

Unit : mm

CS TAPS

Nominal Diameter	Pitch	Overall Length	Thread Length	Shank Diameter	Square Size	Square Length	Tapping Drill Diameter	EDP No.
ØD1	p	L	L1	ØD3	a	L3	Ø d1	
M 16	1	76.20	31.75	12.20	9.04	13.99	15	FBA0206672
M 18	1.5	76.20	31.75	13.78	10.20	15.58	16.5	FBA0206927
M 20	1	82.55	38.10	15.00	11.12	17.16	19	FBA0207014
M 22	1.5	82.55	38.10	17.71	13.17	18.75	20.5	FBA0207156
M 24	1.5	82.55	38.10	19.31	14.37	18.75	22.5	FBA0207271
M 25	1.5	82.55	38.10	20.33	15.13	20.34	23.5	FBA0207387
M 26	1.5	82.35	38.10	20.35	15.13	20.20	24.5	FBA0207445
M 27	1.5	82.35	38.10	20.35	15.13	20.20	25.5	FBA0207501
M 28	1.5	101.40	38.10	21.21	15.77	20.30	26.5	FBA0207615
M 30	1.5	101.40	38.10	22.79	16.96	21.90	28.5	FBA0207700
M 30	2	101.40	38.10	22.79	16.96	21.90	28	FBA0207729
M 32	1.5	101.40	38.10	25.98	19.34	25.20	31.5	FBA0207871
M 40	1.5	101.40	38.10	31.35	23.38	28.20	38	FBA0208239