

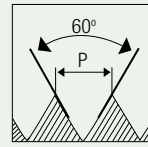

## Carbon Steel Hand Taps



### Metric coarse threads



HOLE TYPE



CS

BS  
949

ZONE  
5

T/S/B

| Nominal Diameter | Pitch | Overall Length | Thread Length | Shank Diameter | Square Size | Square Length | Tapping Drill Diameter |            |
|------------------|-------|----------------|---------------|----------------|-------------|---------------|------------------------|------------|
| ØD1              | p     | L              | L1            | ØD3            | a           | L3            | Ø d1                   | EDP No.    |
| M 2              | 0.4   | 44.03          | 11.5          | 3.25           | 2.58        | 4.46          | 1.6                    | FBA0204977 |
| M 2.2            | 0.45  | 45.72          | 15            | 3.25           | 2.58        | 4.46          | 1.75                   | FBA0205005 |
| M 2.5            | 0.45  | 47.51          | 15            | 3.25           | 2.58        | 4.46          | 2.05                   | FBA0205061 |
| M 3              | 0.5   | 49.4           | 17            | 3.25           | 2.58        | 4.46          | 2.5                    | FBA0205117 |
| M 3.5            | 0.6   | 52.85          | 20.6          | 3.66           | 2.86        | 4.46          | 2.9                    | FBA0205174 |
| M 4              | 0.7   | 56.33          | 22.5          | 4.22           | 3.26        | 6.05          | 3.3                    | FBA0205231 |
| M 4.5            | 0.75  | 62.99          | 26.6          | 4.8            | 3.69        | 6.05          | 3.7                    | FBA0205318 |
| M 5              | 0.8   | 63.29          | 26.6          | 5.41           | 4.15        | 6.05          | 4.2                    | FBA0205404 |
| M 6              | 1     | 67.04          | 30.7          | 6.15           | 4.71        | 6.84          | 5                      | FBA0205632 |
| M 7              | 1     | 67.68          | 30.7          | 7.21           | 5.5         | 7.64          | 6                      | FBA0205716 |
| M 8              | 1.25  | 69.85          | 30.5          | 8.2            | 6.23        | 8.43          | 6.8                    | FBA0205831 |
| M 9              | 1.25  | 74.61          | 33.7          | 9.12           | 6.9         | 10.02         | 7.8                    | FBA0205943 |
| M 10             | 1.5   | 74.61          | 33.7          | 10.29          | 7.73        | 10.02         | 8.5                    | FBA0206091 |
| M 11             | 1.5   | 80.17          | 36.5          | 8.2            | 6.06        | 10.02         | 9.5                    | FBA0206204 |
| M 12             | 1.5   | 85.83          | 42.1          | 9.32           | 6.9         | 10.81         | 10.5                   | FBA0206324 |
| M 12             | 1.75  | 85.83          | 42.1          | 9.32           | 6.9         | 10.81         | 10.2                   | FBA0206356 |
| M 14             | 1.5   | 91.28          | 42            | 10.91          | 8.07        | 12.4          | 12.5                   | FBA0206529 |
| M 14             | 2     | 91.28          | 42            | 10.91          | 8.07        | 12.4          | 12                     | FBA0206560 |

CS TAPS



## Carbon Steel Hand Taps

# M

## Metric coarse threads

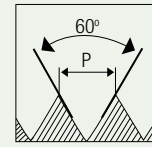

HOLE TYPE



CS

BS  
949

ZONE  
5

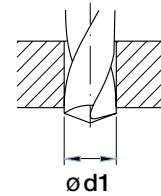
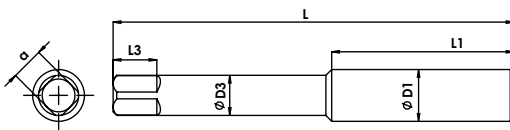

Unit : mm

| Nominal Diameter | Pitch | Overall Length | Thread Length | Shank Diameter | Square Size | Square Length | Tapping Drill Diameter | EDP No.    |
|------------------|-------|----------------|---------------|----------------|-------------|---------------|------------------------|------------|
| ØD1              | p     | L              | L1            | ØD3            | a           | L3            | Ø d1                   |            |
| M 16             | 2     | 96.84          | 46            | 12.2           | 9.04        | 13.99         | 14                     | FBA0206759 |
| M 18             | 2.5   | 102.4          | 46            | 13.78          | 10.2        | 15.58         | 15.5                   | FBA0206986 |
| M 20             | 2.5   | 107.95         | 50.8          | 15             | 11.12       | 17.16         | 17.5                   | FBA0207100 |
| M 22             | 2.5   | 119.06         | 56.4          | 17.71          | 13.17       | 18.75         | 19.5                   | FBA0207215 |
| M 24             | 3     | 124.62         | 56.35         | 19.31          | 14.37       | 18.75         | 21                     | FBA0207359 |
| M 27             | 3     | 129.8          | 63.5          | 20.35          | 15.13       | 20.2          | 24                     | FBA0207559 |
| M 30             | 3.5   | 137.8          | 65            | 22.79          | 16.96       | 21.9          | 26.5                   | FBA0207815 |
| M 33             | 3.5   | 145.8          | 65            | 25.98          | 19.34       | 25.2          | 29.5                   | FBA0208015 |
| M 36             | 4     | 153.8          | 76            | 28.17          | 20.99       | 26.7          | 32                     | FBA0208155 |
| M 39             | 4     | 161.8          | 76            | 31.35          | 23.38       | 28.2          | 35                     | FBA0208211 |
| M 42             | 4.5   | 169.8          | 81            | 33.18          | 24.75       | 28.2          | 37.5                   | FBA0208295 |
| M 45             | 4.5   | 177.8          | 81            | 36.35          | 27.12       | 31.7          | 40.5                   | FBA0208323 |
| M 48             | 5     | 185.3          | 90.5          | 38.61          | 28.82       | 31.7          | 43                     | FBA0208351 |
| M 52             | 5     | 193.3          | 90.5          | 38.61          | 28.82       | 31.7          | 47                     | FBA0208407 |

CS TAPS