

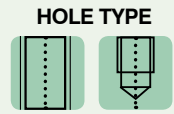

Carbon Steel Hand Taps

BSW

Whitworth coarse threads

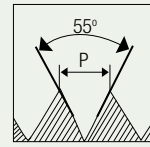

CS

**BS
949**

**ZONE
5**



Nominal Diameter	TPI	Overall Length	Thread Length	Shank Diameter	Square Size	Square Length	Tapping Drill Diameter	EDP No.
ØD1		L	L1	ØD3	a	L3	Ø d1	
1/16"	60	42.19	10.5	3.25	2.58	4.46	-	FBA0200001
3/32"	48	47.41	15	3.25	2.58	4.46	-	FBA0200029
1/8"	40	51.05	18.8	3.25	2.58	4.46	-	FBA0200057
5/32"	32	56.28	22.3	4.04	3.03	6.05	-	FBA0200085
3/16"	24	63.04	26.6	4.8	3.69	6.05	3.7	FBA0200113
7/32"	24	63.56	26.6	5.61	4.3	6.05	4.5	FBA0200141
1/4"	20	67.17	30.7	6.43	4.91	6.84	5.1	FBA0200169
9/32"	20	67.68	30.7	7.21	5.5	7.64	5.8	FBA0200197
5/16"	18	69.85	30.5	8	6.06	8.43	6.5	FBA0200225
3/8"	16	74.61	33.7	9.58	7.38	10.02	7.9	FBA0200253
7/16"	14	80.17	36.5	8.2	6.06	10.02	9.3	FBA0200281
1/2"	12	85.83	42.1	9.32	6.9	10.81	10.5	FBA0200309
9/16"	12	91.28	42	10.91	8.07	12.4	12.1	FBA0200338
5/8"	11	96.84	46	12.2	9.04	13.99	13.5	FBA0200366
11/16"	11	102.4	46	13.78	10.2	15.58	15	FBA0200394

CS TAPS



Carbon Steel Hand Taps

BSW

Whitworth coarse threads

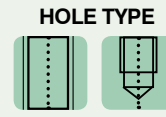
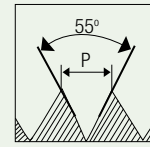

CS

**BS
949**

**ZONE
5**

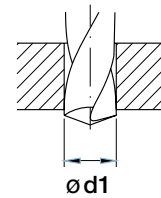
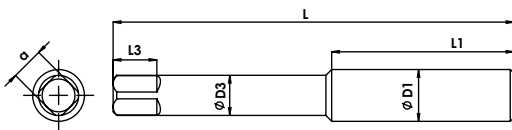

Unit : mm

CS TAPS

Nominal Diameter	TPI	Overall Length	Thread Length	Shank Diameter	Square Size	Square Length	Tapping Drill Diameter	EDP No.
ØD1		L	L1	ØD3	a	L3	Ø d1	
3/4"	10	107.95	50.8	15	11.12	17.16	16.25	FBA0200422
7/8"	9	119.06	56.4	17.71	13.18	18.75	19.25	FBA0200478
1"	8	130.18	63.5	20.33	15.13	20.34	22	FBA0200534
1.1/8"	7	137.8	65	22.79	16.96	21.7	24.75	FBA0200562
1.1/4"	7	145.8	65	25.96	19.34	25.2	28	FBA0200590
1.3/8"	6	153.8	76	28.17	20.99	26.7	31	FBA0200618
1.1/2"	6	161.8	76	31.35	23.38	28.2	33.5	FBA0200646
1.3/4"	5	177.8	81	36.35	27.12	31.7	39	FBA0200702
2"	4.5	193.3	90.5	41.79	31.21	34.7	44.5	FBA0200758