

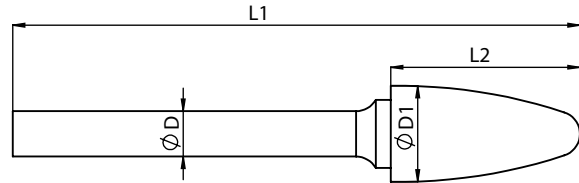

SF

Tree shape with radius end



CARBIDE BURRS



3 mm Shank					Tool No	Standard cut (Single cut)	Supreme cut (Double cut)	Deluxe cut (Diamond cut)	Aluma Cut	Coarse Cut	CTI Number
Head Diameter	Head length	Overall Length	Shank Dia	EDP No.		EDP No.	EDP No.	EDP No.	EDP No.		
ØD1	L2	L1	D								
3	6	38	3	MTB1*	FAC0200714	FAC0200715	FAC0200716	-	-	SF-41M	
3	12.7	38	3	MTB2*	FAC0200717	FAC0200718	FAC0200719	-	-	SF-42M	
3	12.7	50	3	MTB2L*	FAC0200720	FAC0200721	FAC0200722	-	-	-	
3	12.7	75	3	MTB2L1*	FAC0200723	FAC0200724	FAC0200725	-	-	-	

6 mm Shank					Tool No	EDP No.	EDP No.	EDP No.	EDP No.	EDP No.	CTI Number
Head Diameter	Head length	Overall Length	Shank Dia								
6	19	69	6	TB1	FAC0200962	FAC0200963	FAC0200964	-	-	SF-1M	
9.5	19	69	6	TB2	FAC0200971	FAC0200973	FAC0200975	FAC0200986	-	SF-3M	
12.7	25	75	6	TB3	FAC0200988	FAC0200990	FAC0200992	FAC0201002	-	SF-5M	
16	32	82	6	TB4	FAC0201004	FAC0201006	FAC0201008	-	-	-	
8	19	69	6	TB5	FAC0201011	FAC0201012	FAC0201013	FAC0201345	-	SF-2M	
6.3	16	66	6	TB6	FAC0201014	FAC0201015	FAC0201016	-	-	SF-1M	
11	25	75	6	TB7	FAC0201017	FAC0201018	FAC0201020	FAC0201021	-	SF-4M	
16	32	82	6	TB8	FAC0201022	FAC0201024	FAC0201026	FAC0201028	-	SF-6M	
19	25	75	6	TB9	FAC0201030	FAC0201032	FAC0201034	FAC0201036	-	SF-7M	

8 mm Shank					Tool No	EDP No.	EDP No.	EDP No.	EDP No.	EDP No.	CTI Number
Head Diameter	Head length	Overall Length	Shank Dia								
9.5	19	69	8	TB2Z	FAC0200972	FAC0200974	FAC0200976	-	-	-	
12.7	25	75	8	TB3Z	FAC0200989	FAC0200991	FAC0200993	FAC0201288	-	-	
16	32	82	8	TB4Z	FAC0201005	FAC0201007	FAC0201009	FAC0201010	-	-	
16	32	82	8	TB8Z	FAC0201023	FAC0201025	FAC0201027	FAC0201029	-	SF-6M8	
19	25	75	8	TB9Z	FAC0201031	FAC0201033	FAC0201035	FAC0201037	-	SF-7M8	

1/8 inch Shank					Tool No	EDP No.	EDP No.	EDP No.	EDP No.	EDP No.	CTI Number
Head Diameter	Head length	Overall Length	Shank Dia								
1/8	1/4	1-1/2	1/8	MTB1*	FAC0202002	FAC0202004	FAC0202003	-	-	SF-41	
1/8	1/2	1-1/2	1/8	MTB2*	FAC0202005	FAC0202007	FAC0202006	-	-	SF-42	

1/4 inch Shank					Tool No	EDP No.	EDP No.	EDP No.	EDP No.	EDP No.	CTI Number
Head Diameter	Head length	Overall Length	Shank Dia								
1/4	5/8	2-5/8	1/4	TB1I	FAC0202078	FAC0202080	FAC0202079	-	-	SF-1	
3/8	3/4	2-3/4	1/4	TB2I	FAC0202081	FAC0202083	FAC0202082	-	-	SF-3	
7/16	1	3	1/4	TB7I	FAC0202087	FAC0202089	FAC0202088	-	-	SF-4	
1/2	1	3	1/4	TB3I	FAC0202084	FAC0202086	FAC0202085	-	-	SF-5	
5/8	1	3	1/4	TB8I	FAC0202090	FAC0202092	FAC0202091	-	-	SF-6	
3/4	1	3	1/4	TB9I	FAC0202093	FAC0202095	FAC0202094	-	-	SF-7	

* indicates full carbide burrs

Note:

- Ask your local representative about our long shank program –Available in 4", 5", 6", 7", 8", 9", 10", 11" & 12"
- All sizes available as a special in left hand cut
- Coarse cut burrs available on request