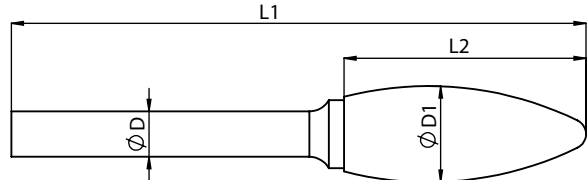

SH
Flame shape

CARBIDE BURRS

3 mm Shank				Tool No	Standard cut (Single cut)	Supreme cut (Double cut)	Deluxe cut (Diamond cut)	Aluma Cut	Coarse Cut	CTI Number
Head Diameter	Head length	Overall Length	Shank Dia		EDP No.	EDP No.	EDP No.	EDP No.	EDP No.	
Ø D1	L2	L1	D							
3	6.3	38	3	MF1*	FAC0200633	FAC0200634	FAC0200635	-	-	SH-41M
3	6.3	50	3	MF1L*	FAC0200636	FAC0200637	FAC0200638	-	-	SH-41ML2
6.3	16	42	3	MF2	FAC0201242	-	-	-	-	-

6 mm Shank				Tool No	Standard cut (Single cut)	Supreme cut (Double cut)	Deluxe cut (Diamond cut)	Aluma Cut	Coarse Cut	CTI Number
Head Diameter	Head length	Overall Length	Shank Dia							
6.3	16	66	6	F1	FAC0200400	FAC0200401	FAC0200402	-	-	SH-1M
8	19	69	6	F2	FAC0200403	FAC0200404	FAC0200405	FAC0200409	-	SH-2M
9.5	25	75	6	F3	FAC0200410	FAC0200411	FAC0200413	FAC0200415	FAC0201423	SH-3M
12.7	32	82	6	F4	FAC0200416	FAC02006418	FAC0200420	FAC0200425	-	SH-5M
16	34	84	6	F5	FAC0200428	FAC0200430	FAC0201279	-	-	SH-6M
19	41	91	6	F6	FAC0200432	FAC0200434	FAC0200436	-	-	SH-7M

8 mm Shank				Tool No	Standard cut (Single cut)	Supreme cut (Double cut)	Deluxe cut (Diamond cut)	Aluma Cut	Coarse Cut	CTI Number
Head Diameter	Head length	Overall Length	Shank Dia							
12.7	32	82	8	F4Z	FAC0200417	FAC0200419	-	-	-	-
16	34	84	8	F5Z	FAC0200429	FAC0200431	FAC0201917	-	-	SH-6M8
19	41	91	8	F6Z	FAC0200433	FAC0200435	FAC0200437	-	-	SH-7M8

1/8 inch Shank				Tool No	Standard cut (Single cut)	Supreme cut (Double cut)	Deluxe cut (Diamond cut)	Aluma Cut	Coarse Cut	CTI Number
Head Diameter	Head length	Overall Length	Shank Dia							
1/8	1/4	1-1/2	1/8	MF11*	FAC0201981	FAC0201983	FAC0201982	-	-	SH-41

1/4 inch Shank				Tool No	Standard cut (Single cut)	Supreme cut (Double cut)	Deluxe cut (Diamond cut)	Aluma Cut	Coarse Cut	CTI Number
Head Diameter	Head length	Overall Length	Shank Dia							
1/4	5/8	2-5/8	1/4	F11	FAC0201905	FAC0201907	FAC0201906	-	-	SH-1
5/16	3/4	2-3/4	1/4	F21	FAC0201908	FAC0201910	FAC0201909	-	-	SH-2
1/2	1-1/4	3-1/4	1/4	F41	FAC0201911	FAC0201913	FAC0201912	-	-	SH-5
5/8	1-5/8	3-5/8	1/4	F51	FAC0201914	FAC0201916	FAC0201915	-	-	SH-6
3/4	1-5/8	3-5/8	1/4	F61	FAC0201918	FAC0201920	FAC0201919	-	-	SH-7

* indicates full carbide burrs

Note:

- Ask your local representative about our long shank program –Available in 4", 5", 6", 7", 8", 9", 10", 11" & 12"
- All sizes available as a special in left hand cut
- Coarse cut burrs available on request