

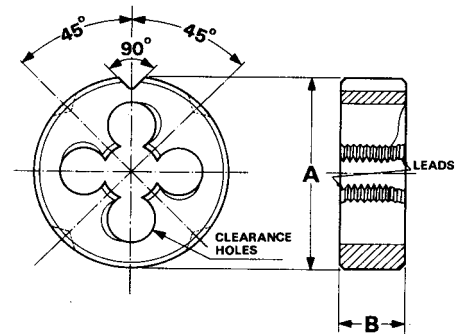

High Speed Steel Ground Dies



O.D. x THICKNESS	SIZE	BSW/BSF	UNC/UNF	BA	BSP
in mm	in mm	No./Inch	No./Inch	No.	Inch
16 x 5	1.6x0.45	-	-	-	-
16 x 5	2.5x0.45	-	-	-	-
16 x 5	2.6x0.45	-	-	-	-
20 x 5	3.0 x 0.50	-	4	6	-
20 x 5	3.5x0.60	-	5	-	-
20 x 5	4.0 x 0.70	5/32"	-	4	-
20 x 5	4.5x0.75	-	-	-	-
20 x 5	-	-	6	-	-
20 x 7	5.0 x 0.80	3/16"	8	2	-
20 x 7	6.0 x 0.50	1/4"	10	-	-
20 x 7	6.0 x 0.75	-	12	-	-
20 x 7	6.0 x 1.00	-	1/4"	-	-
20 x 7	7.0 x 0.75	-	-	-	-
25 x 9	7.0 x 1.00	5/16"	5/16"	-	-
25 x 9	8.00 x 0.75	-	-	-	-
25 x 9	8.00 x 1.00	-	-	-	-
25 x 9	8.00 x 1.25	-	-	-	-
30 x 11	10 x 1.00	3/8"	3/8"	-	1/8"
30 x 11	10 x 1.25	7/16"	7/16"	-	-
30 x 11	10 x 1.50	-	-	-	-
38 x 10	12 x 1.00	1/2"	1/2"	-	-
38 x 10	12 x 1.25	-	-	-	-
38 x 10	12 x 1.50	-	-	-	-
38 x 10	14 x 1.00	-	-	-	-
38 x 10	14 x 1.25	-	-	-	-
38 x 10	14 x 1.50	9/16"	9/16"	-	-
38 x 14	12 x 1.75	-	-	-	1/4"
38 x 14	14 x 2.00	-	-	-	-
45 x 14	16 x 1.00	-	5/8"	-	3/8"
45 x 14	16 x 1.50	-	3/4"	-	1/2"
45 x 14	20 x 1.00	-	-	-	-
45 x 14	20 x 1.50	-	-	-	-
45 x 14	20 x 2.00	-	-	-	-
45 x 18	16 x 2.00	5/8"	-	-	-
45 x 18	18 x 2.50	3/4"	-	-	-
45 x 18	20 x 2.50	-	-	-	-
55 x 16	22 x 1.50	-	-	-	-
55 x 16	24 x 1.50	-	-	-	-
55 x 22	24 x 3.00	-	-	-	-